

8th Floor Plan
Washington Place.

Scale 1/8" = 1'-0"
April 4, 1911
revised April 6, 1911

Asch Building
N.W. Cor. Washington Pl & Greene St.
J.P. Whiskeman } Consulting Engrs.
J.D. Moore }

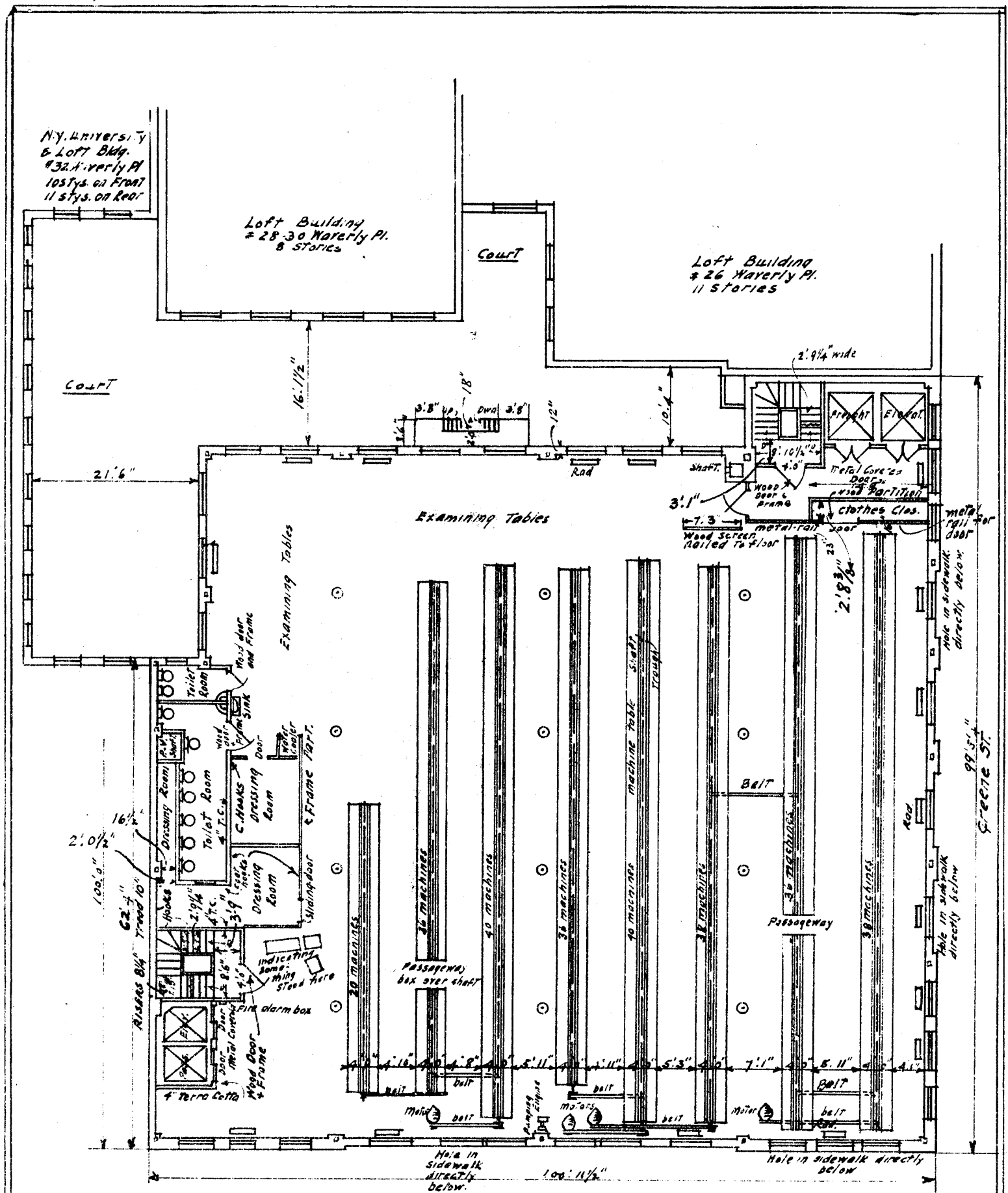

9th Floor Plan.
Washington Place.

Scale $1/16" = 1'-0"$
 April 4, 1911
 Revised April 6, 1911

Asch Building.
N.W. Cor. Washington Pl. & Greene St.
 J.P. Whiskeman } Consulting Engrs.
 J.O. Moore }

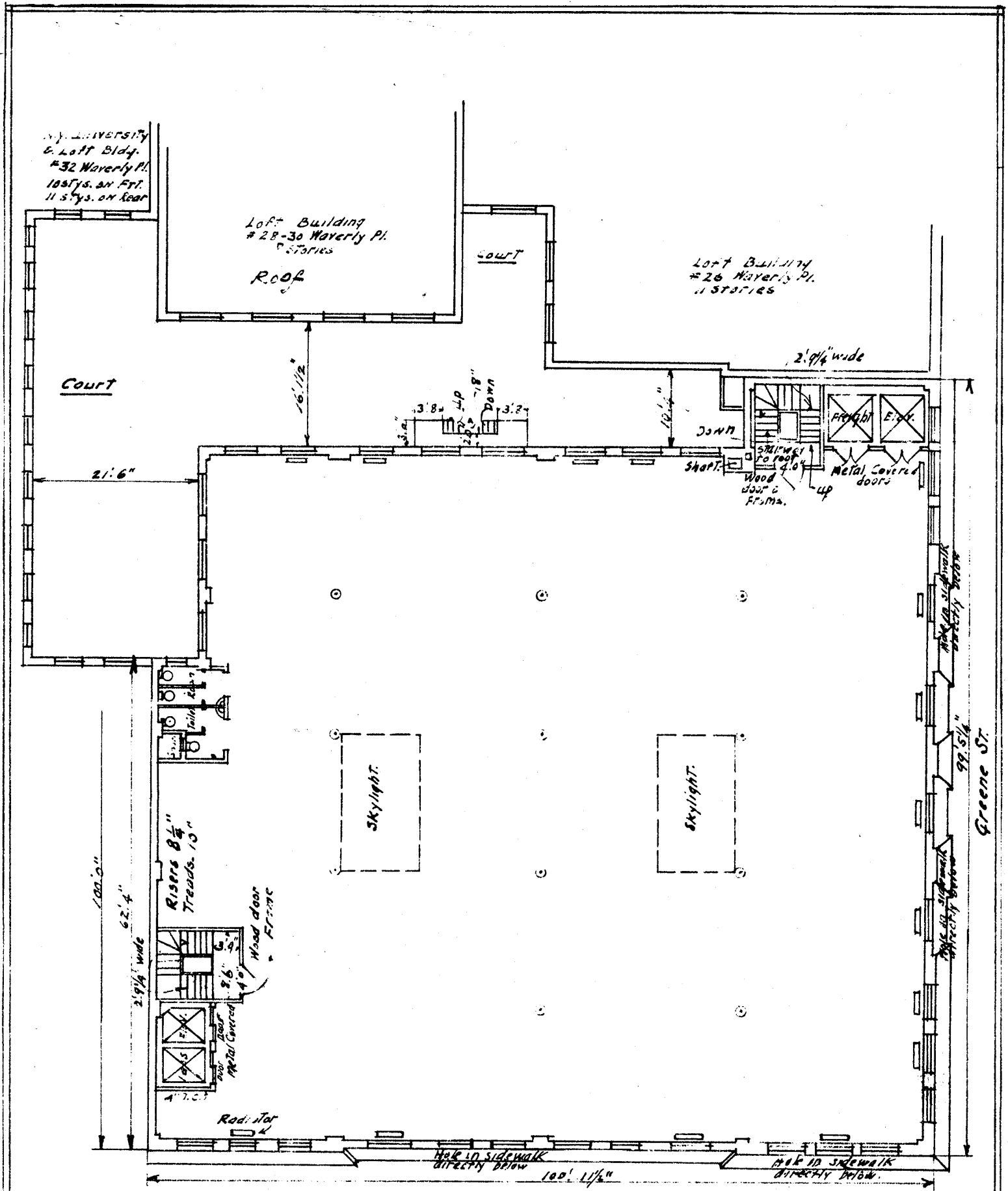

10th Floor Plan.
Washington Place.

Scale 1/8" = 1'-0"
April 4, 1911.

Asch Building.
N.W. cor. Washington Pl. & Greene St.
J.P. Whiskeman } Consulting Engrs.
J.D. Moore